



1

TYPES

- Type **D**: with threaded through bore
- Type **E**: with threaded blind bore



2

Stainless Steel precision casting **A4**

3

- AISI 316

- polished **PL**

4

FEATURES AND APPLICATIONS

Hand knobs GN 6335 satisfy the dimensions of the DIN 6335 (see page) but differ in terms of their non-scooping geometry, which makes cleaning easier and helps prevent possible build-up of dirt.

They are suitable for areas with special hygiene requirements and, thanks to the material used, for applications in highly corrosive environments.



5



6



7



8



9



10



11



12



13



14



15



16



17



18



GN 6335-D

GN 6335-E

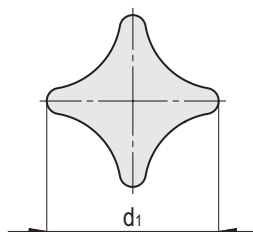
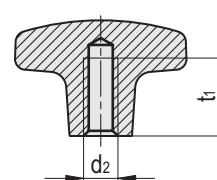
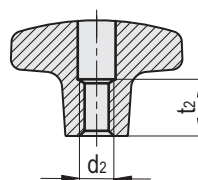
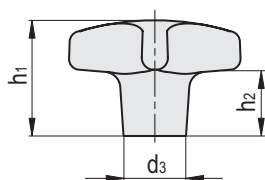

Conversion Table

1 mm = 0.039 inch

d1

mm	inch
32	1.26
40	1.57
50	1.97
63	2.48

GN 6335-D

Code	Description	d1	d2	d3	h1	h2	t2	⚖
GN.29102	GN 6335-A4-32-M6-D-PL	32	M 6	12	20	9	10	36
GN.29106	GN 6335-A4-40-M8-D-PL	40	M 8	14	25	13	13	57
GN.29112	GN 6335-A4-50-M10-D-PL	50	M 10	18	32	18	16	109
GN.29116	GN 6335-A4-63-M12-D-PL	63	M 12	20	40	23	20	194

INOX
STAINLESS
STEEL

METRIC

GN 6335-E

Code	Description	d1	d2	d3	h1	h2	t1 min	⚖
GN.29103	GN 6335-A4-32-M6-E-PL	32	M 6	12	20	9	12	39
GN.29107	GN 6335-A4-40-M8-E-PL	40	M 8	14	25	13	15	59
GN.29113	GN 6335-A4-50-M10-E-PL	50	M 10	18	32	18	18	114
GN.29117	GN 6335-A4-63-M12-E-PL	63	M 12	20	40	23	22	207

INOX
STAINLESS
STEEL

METRIC